

# SinBerBEST Recommendations for Singapore Buildings during COVID-19 Circuit Breaker

## Background

On 13 March 2020 World Health Organization (WHO) declared COVID-19 as a pandemic [1-2]. Individual hygiene, disinfection practice, isolation, and physical distancing measures have been advocated by the WHO and Singapore Ministry of Health as the main means to control the spread of COVID-19 [1-10].

With the intent to reduce the risk of COVID-19 spread further, [SinBerBEST](#) provides this Air Conditioning and Mechanical Ventilation (ACMV) expert recommendations document for Singapore commercial, institutional and residential buildings that are operating during the Circuit Breaker period [11, 12]. It is aimed at:

- Facility managers that operate buildings;
- Managers and Administrators for schools and childcare centers; and
- Homeowners of public and private residences and operators of dormitories.

This document follows the use of the precautionary principle to reduce potential risks associated with plausible routes of COVID-19 spread. This document takes into account the context in Singapore [11-14]. It is based on our professional judgment and evidence collected from studies of other infectious agents [15-22] and limited evidence from studies on COVID-19 [24-26]. These recommendations should come after the recommended primary measures, for example, individual hygiene, disinfection practice, isolation, and physical distancing measures [1-10].

## How COVID-19 spreads

The WHO reports [1] that *“COVID-19 is transmitted via droplets and fomites during close unprotected contact between an infector and infectee. The airborne spread has not been reported for COVID-19 and it is not believed to be a major driver of transmission based on available evidence; however, it can be envisaged if certain aerosol-generating procedures are conducted in health care facilities. Fecal shedding has been demonstrated by some patients, and the viable virus has been identified in a limited number of case reports. However, the fecal-oral route does not appear to be a driver of COVID-19 transmission; its role and significance for COVID-19 remain to be determined.”*

We acknowledge that the airborne transmission route is not the main one. Measures to reduce the potential airborne route are secondary to others but should be applied if only small negative effects are caused by them. Our recommendations are based on increasing ventilation rate [15,16,18, 29-34] and enhancing air cleaning [17,28,35,41] as much as technically, environmentally, and economically feasible.

## General recommendations for buildings

- **Increase to 100% outdoor air intake in air-conditioned buildings.** In buildings with ACMV systems, outdoor air supply shall be set to the maximum setting to enhance dilution indoors. Operation times shall be extended to commence the system at least 2 hours before the first occupant arrives and switch off 2 hours after all occupants have left. Since many office workers are currently on staggered working hours, with staff arriving as early as 7.30 am, leaving late at 7.30 pm, the recommended operation times will be from 5.30 am to 9.30 pm. Demand control ventilation and features that only turn on the supply air when the occupants are in the room shall be disengaged. If a carbon dioxide sensor is present, the closer the indoor carbon dioxide concentration to the outdoor value (410 ppm), the better.
- **Stop recirculation in air-conditioned buildings.** For air-conditioned buildings that have the capacity to operate with 100% outdoor air (no recirculation), they should be operated in such conditions. The return air dampers

should be closed and the outdoor air intake damper fully open. The operator should verify that acceptable conditions are maintained indoors. If full closing of the recirculation air is not possible for adequate comfort (for example, the air temperature above 27°C), the recirculation air should be kept at a minimum level and shall be treated with high-efficiency media-based filters in place in the AHU and/or localized air cleaning using HEPA-based PACs in the office (see below).

- **Stop rotary exchangers in air-conditioned buildings.** Rotary heat exchangers or heat wheels shall be switched off and leaks identified and sealed to prevent exhaust/recirculated air from getting entrained (bypass) into the supply air.
- **Open windows and turn off or use less often air-conditioning in naturally ventilated buildings.** For naturally ventilated buildings with operable windows, windows shall be fully opened to allow air to flow indoors without obstacles, ideally in the opposite side of a building, to the extent that meets safety requirements and acceptability of outdoor noise and/or air pollution. Increased air motion, such as from a ceiling fan, can be used. If air-conditioning is used in buildings designed to be naturally ventilated (such as residential buildings), it is recommended that sufficient outdoor air be provided by keeping the windows a bit open in every room, air-conditioning can be used to provide comfort but higher energy use is expected.
- **Enhance air cleaning.** High-efficiency media-based filters, preferably MERV 14 (ASHRAE 52.2) [37] or F7 (EN 779 / EN 1822) [38,39] shall be installed and operated in the Air Handling Unit that serves the return and outdoor air. The filters shall be properly installed and well-sealed to prevent filter bypass. The filters shall be regularly inspected to ensure no leakage and that it is not fully loaded. Adequate precaution shall be taken when changing the filters (done while the system is off, wearing personal protection equipment and gloves) and disposing of them.
- **Use Ultra-Violet Germicidal Irradiation (UVGI).** Other physical means of cleaning the air, such as UVGI (portable, upper room, in-room, and in the airstream) may be used [17,28].

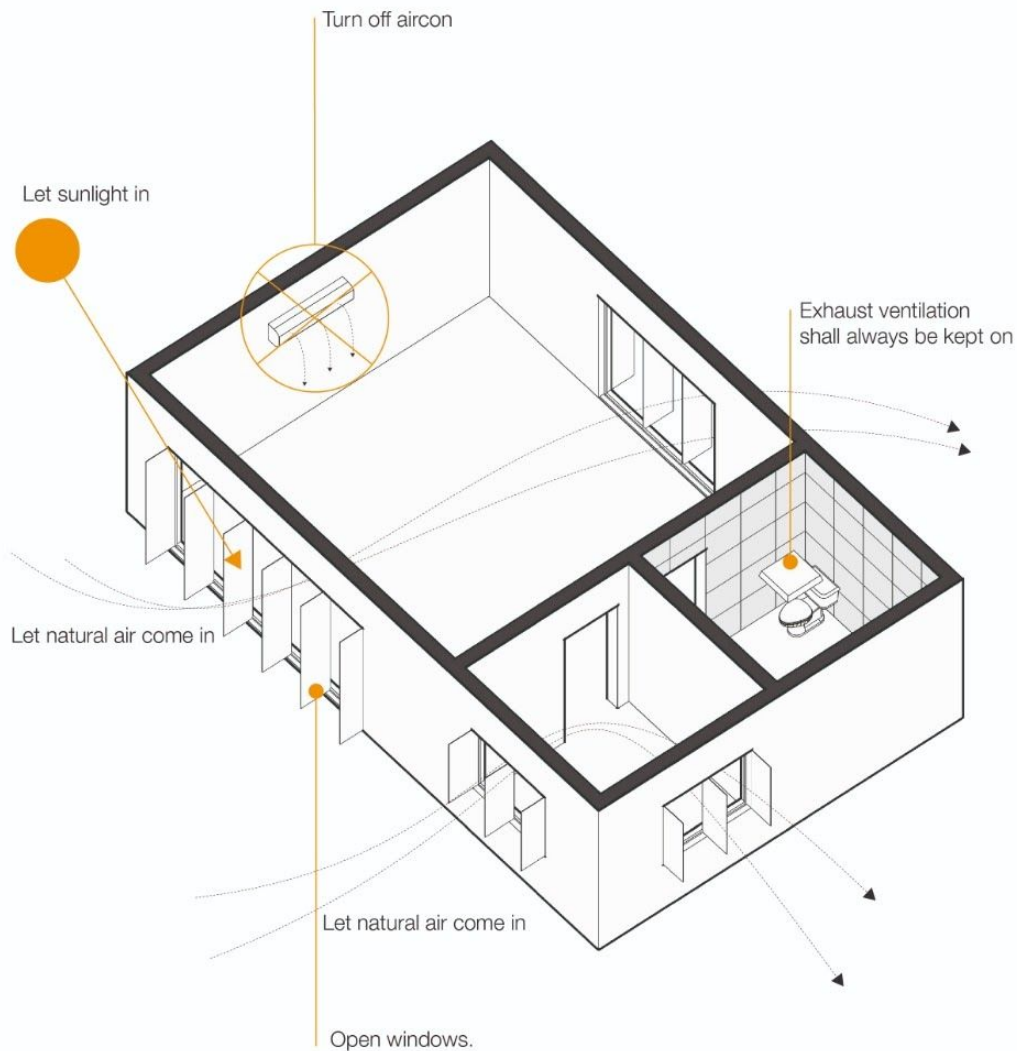

**Figure 1.** Diagram showing some of the recommendations given for naturally ventilated buildings.

- **Use Portable Air Cleaners (PACs).** For mechanically ventilated buildings and air-conditioned schools and childcare centers, high efficiency HEPA-based portable air cleaner may be deployed in a small room [35,40,41]. The selection of PACs depends on its performance (clean air delivery rates (CADR)). For larger indoor space, the numbers of PACs to be deployed shall be based on the performance of the PAC (CADR) and the space volume [35,40,41]. The use of PACs will have minimal impact in naturally ventilated buildings.
- **Let the sunlight in.** Where possible and taking into account building safety and acceptability, windows and blinds shall be opened to allow sunlight and thus UV entry indoors.
- **Keep exhaust ventilation always on.** Exhaust ventilation shall always be kept on 24/7, and ensured that the toilet is under-pressure (lower pressure than outdoor) to avoid the fecal-oral transmission [22].
- **Consider the airflow pathway (air distribution) in social distancing.** Singapore Ministry of Manpower is enforcing safe distancing measures in workplaces. As there have been reports on airflow causing spreading of the virus [23], it is recommended the occupancy layout for social distancing take into consideration of airflow patterns and pathways, e.g. staggered layout instead of linear placement of live workstations.

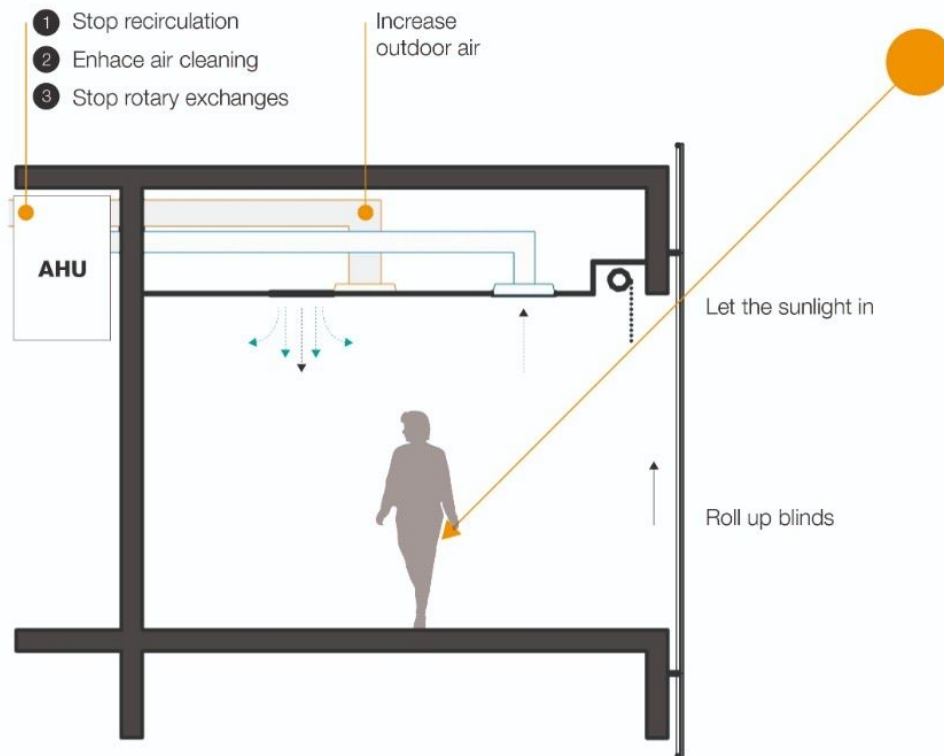

**Figure 2.** Diagram showing some of the recommendations given for mechanically ventilated buildings.

### Specific recommendations for residences with Person of Interest (POI)

- A person of interest in this document is defined as individuals issued with Stay-Home-Notice (SHN) [5], Leave of Absence (LOA) [3,4], or displaying COVID-19 like symptoms and not a confirmed case.
- All the room windows of the POI shall be opened without opening the door that links to the rest of the house. If the toilet attached to the POI room has an exhaust fan, it shall be turned on all the time. The door gaps of the POI room shall be sealed to ensure the air does not leak into the rest of the house.
- If doable, high-efficiency HEPA-based PAC is to be deployed in the room of the POI. Adequate precaution shall be taken when changing the filters (wearing personal protection equipment and gloves) and disposing of them. Additionally, portable UVGI (portable or upper room) may be installed in the room of the POI.

### Disclaimer

The recommendations expressed in this document are based on current knowledge, in good faith and while every care has been taken in preparing this document, BEARS/SinBerBEST gives no warranty and accepts no responsibility or liability for the accuracy or the completeness of the information and materials contained in this document. Under no circumstances will BEARS/SinBerBEST be held responsible or liable in any way for any claims, damages, losses, expenses, costs or liabilities whatsoever (including, without limitation, any direct or indirect damages for loss of profits, business interruption or loss of information) resulting from or arising directly or indirectly from your use of or inability to use this document or any information linked to it, or from your reliance on the information and material on this document, even if BEARS/SinBerBEST has been advised of the possibility of such damages in advance.

### References

1. WHO, 2020. Report of the WHO-China Joint Mission on Coronavirus Disease 2019 (COVID-19).16-24 February 2020.  
<https://www.who.int/docs/default-source/coronaviruse/who-china-joint-mission-on-covid-19-final-report.pdf>
2. China Centers for Disease Control and Prevention. 2020. General questions COVID-19 Prevention and Control. Beijing, China. <http://www.chinacdc.cn/en/COVID19/202002/P020200306358351973919.pdf>
3. Ministry of Health Singapore. 2020. Circuit Breaker to Minimise Further Spread of COVID-19  
<https://www.moh.gov.sg/news-highlights/details/circuit-breaker-to-minimise-further-spread-of-covid-19>
4. Ministry of Health Singapore. 2020. Advisory for Individuals Sharing Residential Spaces with Persons on Leave of Absence (LOA) - 02 Feb 2020.  
<https://www.moh.gov.sg/docs/librariesprovider5/default-document-library/advisory-for-individuals-sharing-residential-spaces-with-persons-on-leave-of-absence---02-feb-2020.pdf>
5. Ministry of Health Singapore. 2020. Health Advisory for Persons Placed on Leave of Absence (LOA) - 01 Feb 2020.  
<https://www.moh.gov.sg/docs/librariesprovider5/default-document-library/moh-health-advisory-for-persons-placed-on-leave-of-absence---01-feb-2020-1850h.pdf>
6. Ministry of Health Singapore. 2020. MOH Health Advisory for Persons Issued Stay-Home Notice. 18 Mar 2020.  
[https://www.moh.gov.sg/docs/librariesprovider5/2019-ncov/moh-health-advisory-for-persons-issued-stay-home-notice-\(updated-18-mar\).pdf](https://www.moh.gov.sg/docs/librariesprovider5/2019-ncov/moh-health-advisory-for-persons-issued-stay-home-notice-(updated-18-mar).pdf)
7. Ministry of Manpower Singapore. 2020. Advisory on safe social distancing measures at the workplace. 13 March 2020. <https://www.mom.gov.sg/covid-19/advisory-on-social-distancing-measures>
8. National Environmental Agency Singapore. 2020. Interim Guidelines for Environmental Cleaning and Disinfection of Areas Exposed to Confirmed Case(s) of COVID-19 in Non-Healthcare Premises. 25 January 2020.  
<https://www.nea.gov.sg/our-services/public-cleanliness/environmental-cleaning-guidelines/guidelines/guidelines-for-environmental-cleaning-and-disinfection>
9. National Environmental Agency Singapore. 2020. Interim Guidelines for Environmental Cleaning and Disinfection in Residences That May Be Exposed to the COVID-19 Virus. 28 January 2020.  
<https://www.nea.gov.sg/our-services/public-cleanliness/environmental-cleaning-guidelines/guidelines/interim-guidelines-for-environmental-cleaning-and-disinfection-in-residences>
10. National Environmental Agency Singapore. 2020. Interim Guidelines for Environmental Cleaning and Disinfection of Premises With Transient Exposure to Confirmed Cases(s) of the COVID-19. 12 February 2020.  
<https://www.nea.gov.sg/our-services/public-cleanliness/environmental-cleaning-guidelines/guidelines/interim-guidelines-for-environmental-cleaning-and-disinfection-of-premises-with-transient-exposure-to-confirmed-cases-of-the-novel-coronavirus>
11. ChannelNewsAsia. 2020. COVID-19 circuit breaker extended until Jun 1 as Singapore aims to bring down community cases ‘decisively’: PM Lee. 22 April 2020.  
<https://www.channelnewsasia.com/news/singapore/covid-19-circuit-breaker-extended-june-pm-lee-speech-apr-21-12662054>
12. Straits Times, 2020. COVID-19 circuit breaker measures: What you can and cannot do till May 4. 22 April 2020.  
<https://www.straitstimes.com/singapore/a-new-normal>
13. SS 553:2015. Code of Practice for Air-conditioning and mechanical ventilation in buildings
14. SS 554:2015. Code of Practice for Indoor air quality for air-conditioned buildings
15. Brundage, J.F., Scott, R.M., Lednar, W.M., Smith, D.W., Miller, R.N., 1988. Building-associated risk of febrile acute respiratory diseases in army trainees. JAMA 249 (14), 2108–2112
16. Li, Y., Leung, G.M., Tang, J.W., Yang, X., Chao, C.Y.H., Lin, J.Z., Lu, J.W., Nielsen, P.V., Niu, J., Qian, H., Sleight, A.C., Su, H.-J.J., Sundell, J., Wong, T.W., Yuen, P.L., 2007. Role of ventilation in airborne transmission of infectious agents in the built environment – a multidisciplinary systematic review. Indoor Air 17, 2–18
17. Miller-Leiden S, Lobascio C, Nazaroff WW, Macher JM. Effectiveness of in-room air filtration and dilution ventilation for tuberculosis infection control. Journal of Air & Waste Management Association 1996. 46(9): 869-82.
18. Milton DK, Glencross PM, Walters MD. 2000. Risk of sick leave associated with outdoor air supply rate, humidification, and occupant complaints. Indoor Air. 10(4):212-21.

19. Milton, D.K., Patricia, Fabian M., Cowling, B.J., Grantham, M.L., McDevitt, J.J., 2013. Influenza virus aerosols in human exhaled breath: particle size, culturability, and effect of surgical masks. *PLoS Pathog.* 9 (3), e1003205.
20. Tellier, R., 2009. Aerosol transmission of influenza A virus: a review of new studies. *J. R. Soc. Interface* 6, S783–S790.
21. Riley, E.C., Murphy, G., Riley, R.L., 1978. Airborne spread of measles in a suburban elementary school. *Am. J. Epidemio.* 107 (5), 421–432.
22. Yu, I.T.S., Li, Y., Wong, T.W., Tam, W., Chan, A.T., Lee, J.H.W., Leung, D.Y.C., Ho, T., 2004. Evidence of airborne transmission of the severe acute respiratory syndrome virus. *N. Engl. J. Med.* 350, 1731–1739
23. Lu J, Gu J, Li K, Xu C, Su W, Lai Z, et al. COVID-19 outbreak associated with air conditioning in restaurant, Guangzhou, China, 2020. *Emerg Infect Dis.* 2020 Jul. <https://doi.org/10.3201/eid2607.200764>
24. van Doremalen N, Bushmaker T, Morris DH, Holbrook MG, Gamble A, Williamson BN, Tamin A, Harcourt JL, Thornburg NJ, Gerber SI, Lloyd-Smith JO, de Wit E, Munster VJ. Aerosol and Surface Stability of SARS-CoV-2 as Compared with SARS-CoV-1. *New England Journal of Medicine.* 2020 Mar 17.
25. Ong SWX, Tan YK, Chia PY, et al. 2020. Air, Surface Environmental, and Personal Protective Equipment Contamination by Severe Acute Respiratory Syndrome Coronavirus 2 (SARS-CoV-2) From a Symptomatic Patient. *JAMA.*
26. Liu Y, Ning Z, Chen Y, Guo M, Liu Y, Gali NK, Sun L, Duan Y, Cai J, Westerdahl D, Liu X, Ho KF, Kan H, Fu Q, Lan K. Aerodynamic Characteristics and RNA Concentration of SARS-CoV-2 Aerosol in Wuhan Hospitals during COVID-19 Outbreak. non-peer reviewed preprint. bioRxiv.
27. Centers for Disease Control and Prevention. 2020. What you need to know about coronavirus disease 2019 (COVID-19) <https://www.cdc.gov/coronavirus/2019-ncov/downloads/2019-ncov-factsheet.pdf>
28. Menzies D, Popa J, Hanley JA, Rand T, Milton DK. 2003. Effect of ultraviolet germicidal lights installed in office ventilation systems on workers' health and wellbeing: double-blind multiple crossover trial. *The Lancet* 362 (9398), 1785-1791
29. Myatt TA, Johnston SL, Zuo Z, Wand M, Keadze T, Rudnick S, Milton DK. 2004. Detection of airborne rhinovirus and its relation to outdoor air supply in office environments. *American journal of respiratory and critical care medicine* 169 (11), 1187-1190
30. Myatt, T.A., Johnston, S.L., Zuo, Z.F., Wand, M., Keadze, T., Rudnick, S., Milton, D.K., 2004. Detection of airborne rhinovirus and its relation to outdoor air supply in office environments. *Am. J. Respir. Crit. Care. Med.* 169, 1187–1190
31. Nardell, E.A., Keegan, J., Cheney, S.A., Etkind, S.C., 1991. Airborne infection. Theoretical limits of protection achievable by building ventilation. *Am. Rev. Respir. Dis.* 144 (2), 302–306.
32. Sun, Y.X., Wang, Z.G., Zhang, Y.F., Sundell, J., 2011. In China, students in crowded dormitories with a low ventilation rate have more common colds: evidence for airborne transmission. *PLoS ONE* 6 (11), e27140
33. Zhu S, Jenkins S, Addo K, Heidarinejad M, Romo SA, Layne A, Ehizibolo J, Dalgo D, Mattise NW, Hong F, Adenaiye OO, Bueno de Mesquita JP, Albert BJ, Washington-Lewis R, German J, Tai S, Youssefi S, Milton DK, Srebric J. Ventilation and laboratory-confirmed acute respiratory infection (ARI) rates in college residence halls in College Park, Maryland. *Environ Int.* 2020; 137:105537.
34. Cedeno Laurent JG, Allen JG, McNeely E, Dominici F, Spengler JD. 2020. Influence of the residential environment on undergraduate students' health. *J Expo Sci Environ Epidemiol.*;30(2):320-327.
35. Zuraimi MS, GJ Nilsson, RJ Magee. 2011. Removing indoor particles using portable air cleaners: implications for residential infection transmission. *Building and environment* 46 (12), 2512-2519
36. Rudnick SN, Milton DK 2013. Risk of indoor airborne infection transmission estimated from carbon dioxide concentration *Indoor air* 13 (3), 237-245
37. ASHRAE 52.2 Standard 52.2-2017. Method of Testing General Ventilation Air-Cleaning Devices for Removal Efficiency by Particle Size.
38. EN 779. 2012. Particulate air filters for general ventilation. Determination of the filtration performance
39. EN 1822. 2019. High-efficiency air filters (EPA, HEPA, and ULPA). Classification, performance testing, marking
40. ANSI/AHAM AC-1-2006 Method for Measuring Performance of Portable Household Electric Room Air Cleaners.
41. Shaughnessy, R.J.; R. G. Sextro, 2006. What Is an Effective Portable Air Cleaning Device? A Review. *Journal of Occupational and Environmental Hygiene.* 3: 169–181.